

# Ear muff "Z2"

## The Moldex ear muff Z2

- Z2 (6220)
- Hygiene kit (6105)

### Characteristics

The Moldex Z2 is ideal to protect from intermittent noise - or for those who cannot achieve a safe and comfortable fit with earplugs.

All Moldex hearing products have been designed with the user in mind. High levels of comfort have been engineered into the products without compromising the optimal protection.

### Construction / Materials

Moldex ear muff and hygiene kit are made of the following materials:

- Cup = Polypropylene
- Cup-foam = Polyurethane
- Cushion foam = Polyurethane
- Cushion = Vinyl
- Head band = Polyacetale

Weights: 241 g

### Certification

The Moldex Z2 meets the requirements of EN352 and is CE-marked in accordance with the requirements of European Directive 89/686/EEC.

The BGIA in St. Augustin in Germany is the body responsible for type examination (Article 10).

The product is manufactured in an ISO 9001 certified plant.

### Testing

The Z2 has been tested to EN 352 and fulfills all requirements of the relevant categories.

#### • Ignitability

The ear muff will not ignite upon application of a heated rod, nor continue to glow after the removal of the heated rod.

#### • Construction

All parts of the ear muff are designed and manufactured so that they are not liable to cause physical damage to the wearer when fitted and used according to the instructions.

### Attenuation Data

The Moldex Z2 passes the EN 352 minimum attenuation requirements set out in the table below. The A.P. V. values ( $M_f$ - $S_f$ ) of the ear muff must exceed the data in the table.

Minimum attenuation requirement (dB)								
Freq. (Hz)	63	125	250	500	1000	2000	4000	8000
A.P.V (dB)	-	5.0	8.0	10.0	12.0	12.0	12.0	12.0

Full attenuation data tables for the Moldex Z2:

		Z2 (6220): worn on head							
A	Freq. (Hz)	125	250	500	1000	2000	4000	8000	
	$M_f$ (dB)	12,8	20,8	28,0	35,2	34,1	36,8	36,5	
	$S_f$ (dB)	3,7	3,0	2,9	4,2	4,2	3,2	7,1	
	A.P.V (dB)	9,1	17,8	25,1	31,0	29,9	33,6	29,4	
Size: M/L		SNR = 28 dB		H = 31		M = 26		L = 17	

### Instructions For Use

- The ear muff must be used in accordance with the relevant national legislation, and fitted, adjusted and maintained according to the user instructions.
- Warning: Disregarding the user and fitting instructions for this product can affect the product efficiency in protecting against noise.
- Check the ear muff and cushions before use. Change them if they are damaged.
- Ear muffs, and in particular cushions, may deteriorate with use and should be examined at frequent intervals, for cracking and leakage for example.
- Products should be stored in a cool, non-contaminated and dry environment. They should not be exposed to direct sunlight or heat.
- The product may be adversely affected by direct contact with certain chemical substances (e.g. aromatic hydrocarbons).
- Ear muffs are reusable provided the hygiene of the product is maintained between uses. Clean with mild soap and water.
- We suggest replacing cushions and inserts from the hygiene kit every 6 months. This will ensure optimum levels of comfort and protection are maintained. The fitting of "hygiene covers" to the cushions may affect the acoustic performance of the ear muffs.

### Instructions for fitting: Z2 (6220)

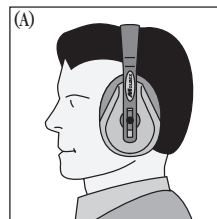

(A) Z2 on head:

When putting on the ear muff, the headband needs to be positioned in the middle of the head and the cushions need to cover the ears.

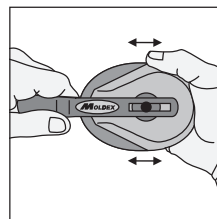

The position of the cup can be changed by moving the headband.

### Hygiene kit (6105)

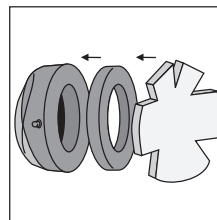

The foam inserts and cushions are detachable and can be replaced by spare parts from the "hygiene kit" (product Number 6105).

MOLDEX-METRIC AG & Co. KG  
Unit 9, Glaisdale Point,  
Off Glaisdale Drive, Bilborough,  
Nottingham. NG8 4GP

Tel.: +44 (0)115 985 4288  
Fax: +44 (0)115 985 4211  
www.moldex-europe.com  
info@uk.moldex-europe.com

# MOLDEX



MOLDEX-METRIC AG & Co. KG  
Unit 9, Glaisdale Point,  
Off Glaisdale Drive, Billborough,  
Nottingham. NG8 4GP

Tel.: +44 (0)115 985 4288  
Fax: +44 (0)115 985 4211  
[www.moldex-europe.com](http://www.moldex-europe.com)  
[info@uk.moldex-europe.com](mailto:info@uk.moldex-europe.com)

**MOLDEX**